

July 4-1887-

351

Measurement of water in Weber River

at Mouth of Water Canyon: $\frac{3}{4}$ of 1 cu. ft per second

$\frac{3}{4}$ deducted for boulders

106

Cross Section

43 Ft wide

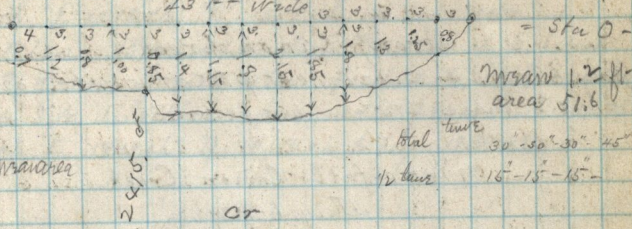

Measure

or

50 Ft wide

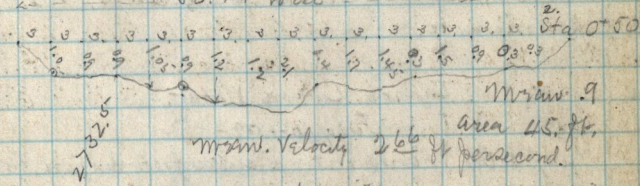

N 32' 1/2' W

Mean Velocity 2.66 ft per second

55 ft wide

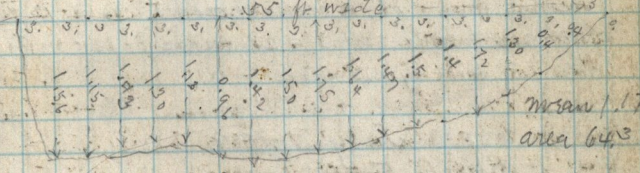

Mean 1.17
area 64.3

Measurements of Vertical Creek at the junction or point where H. Garners Creek begins

$\frac{1}{10}$ of the total creek filled a box of 1 cubic foot in 5" being the mean of 8 measurements

$92.1 \frac{1}{10} \text{ c.f.} = 36 \text{ cubic ft per minute (day 32 cubic ft)}$

July 5-

Measurement of Birch Creek point where creek crosses the Road in mouth of Canyon $\frac{1}{10}$ of creek fills a box of 1 cubic foot in 6 seconds. being the mean of 14 trials.

$1 \frac{1}{10} = 40 \text{ cubic inches per second}$